

ULTRA Bow Roller Selection Table

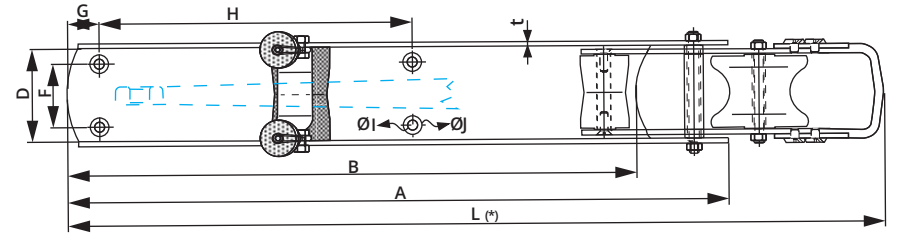
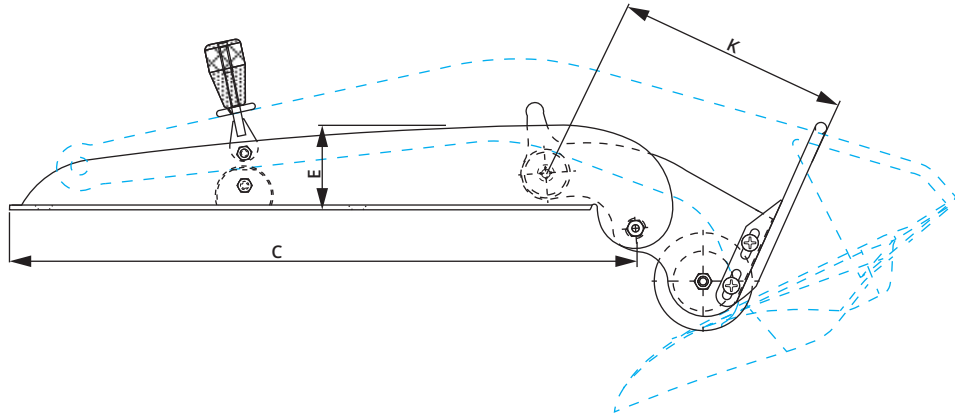

- All measurements in inches.

- If dimension "A" or "B" is given together with the order by customer, it can be manufactured in different lengths

- The bow roller chassis is either manufactured without holes to not let potential problems on mounting and drilled by the customer or it is manufactured with holes, if the dimensions of "F,G,H,I,J" are given together with the order by the customer.

- (*) "L" is the approximate dimension given for the current drawing, shows variety with car movements.

We reserve the right to make changes to design and measurements.

This document was updated on the 08.11.2024.

For the latest version, please visit www.ultraproductswest.com

UltraProducts
West

Anchor kg/lbs	5/11	8/18	12/26	16/35	21/46	27/60	35/77	45/100	60/132	80/176	100/220	130/290	160/350	200/440
A	15.62	18.27	20.91	23.02	25.19	27.4	29.89	32.48	35.75	39.15	42.4	46.26	49.58	53.4
B	13.47	15.76	18.04	19.85	21.72	23.63	25.75	28.02	29.06	33.94	36.96	39.91	42.76	46.07
C	14.74	17.24	19.74	21.73	23.78	25.87	28.22	30.66	33.75	37.14	40.02	43.68	46.8	50.42
D	2.17	2.54	2.91	3.2	3.51	3.81	4.16	4.52	4.98	5.48	5.9	6.44	6.9	7.43
E	1.99	2.33	2.67	2.93	3.21	3.49	3.81	4.14	4.56	5.01	5.4	5.89	6.31	6.8
K	5.56	6.5	7.44	8.19	8.96	9.74	10.63	11.55	12.71	13.99	15.08	16.45	17.63	19
L(*)	21.1	22.56	25.83	28.39	31.1	33.82	36.89	40.08	44.13	48.58	52.32	57.09	61.22	65.94
t	.12	.16	.16	.16	.20	.20	.24	.24	.24	.30	.30	.30	.39	.39